



# ASPEN MEADOWS

SALAMANDER COLLECTION

WALKING TIME: 8 minutes

1 Walter Isaacson Center to

10 Walter Paepcke Memorial Building

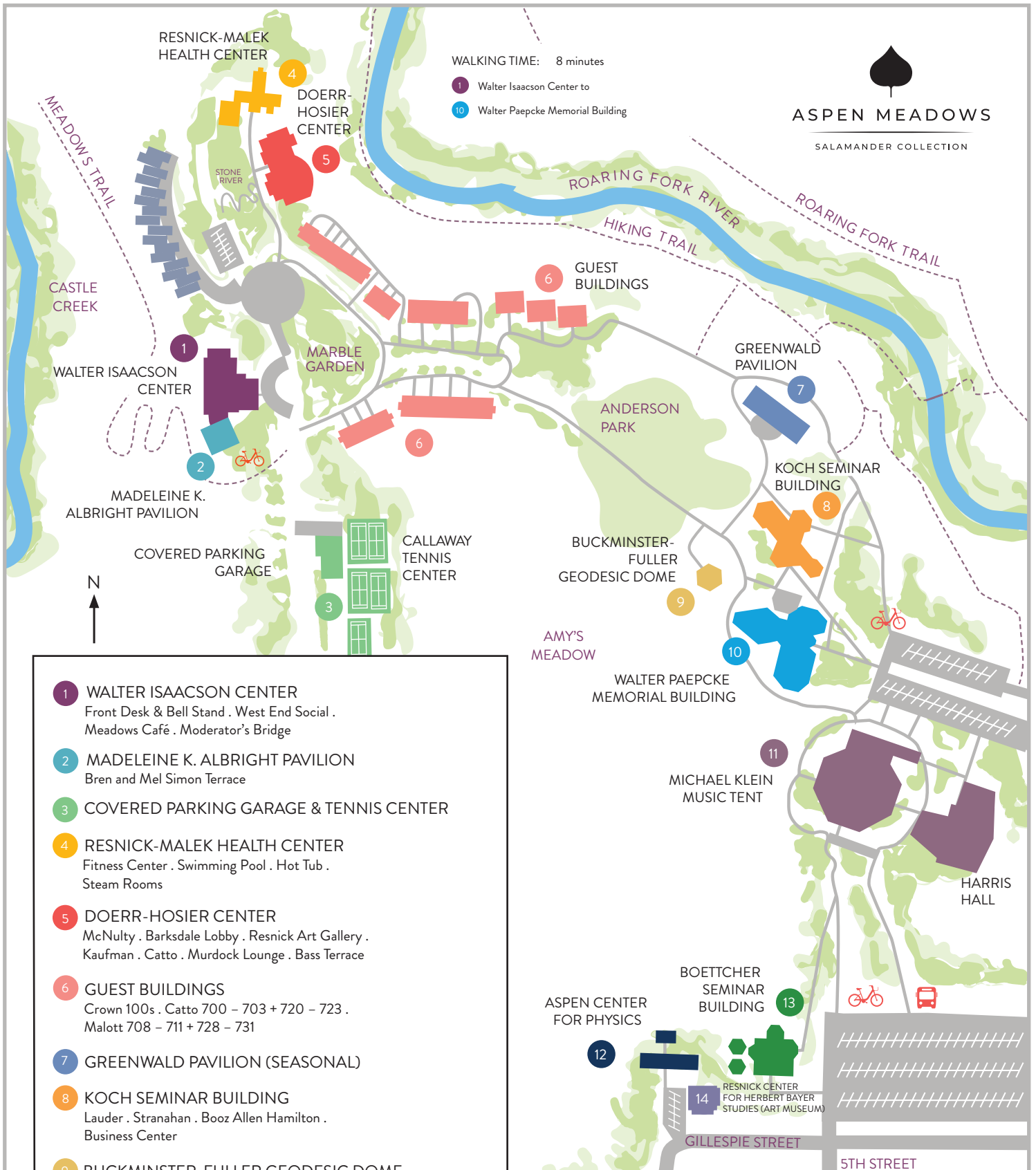

- 1 WALTER ISAACSON CENTER  
Front Desk & Bell Stand . West End Social .  
Meadows Café . Moderator's Bridge
- 2 MADELEINE K. ALBRIGHT PAVILION  
Bren and Mel Simon Terrace
- 3 COVERED PARKING GARAGE & TENNIS CENTER
- 4 RESNICK-MALEK HEALTH CENTER  
Fitness Center . Swimming Pool . Hot Tub .  
Steam Rooms
- 5 DOERR-HOSIER CENTER  
McNulty . Barksdale Lobby . Resnick Art Gallery .  
Kaufman . Catto . Murdock Lounge . Bass Terrace
- 6 GUEST BUILDINGS  
Crown 100s . Catto 700 - 703 + 720 - 723 .  
Malott 708 - 711 + 728 - 731
- 7 GREENWALD PAVILION (SEASONAL)
- 8 KOCH SEMINAR BUILDING  
Lauder . Stranahan . Booz Allen Hamilton .  
Business Center
- 9 BUCKMINSTER-FULLER GEODESIC DOME
- 10 WALTER PAEPCKE MEMORIAL BUILDING  
Auditorium . Gallery . Library
- 11 MICHAEL KLEIN MUSIC TENT & HARRIS HALL
- 12 ASPEN CENTER FOR PHYSICS

- 13 BOETTCHER SEMINAR BUILDING  
Dingman . Harris . Hudson Commons
- 14 RESNICK CENTER FOR HERBERT BAYER STUDIES (ART MUSEUM)



WE-CYCLE STATION



RFTA CROSSTOWN SHUTTLE



# ASPEN MEADOWS

SALAMANDER COLLECTION

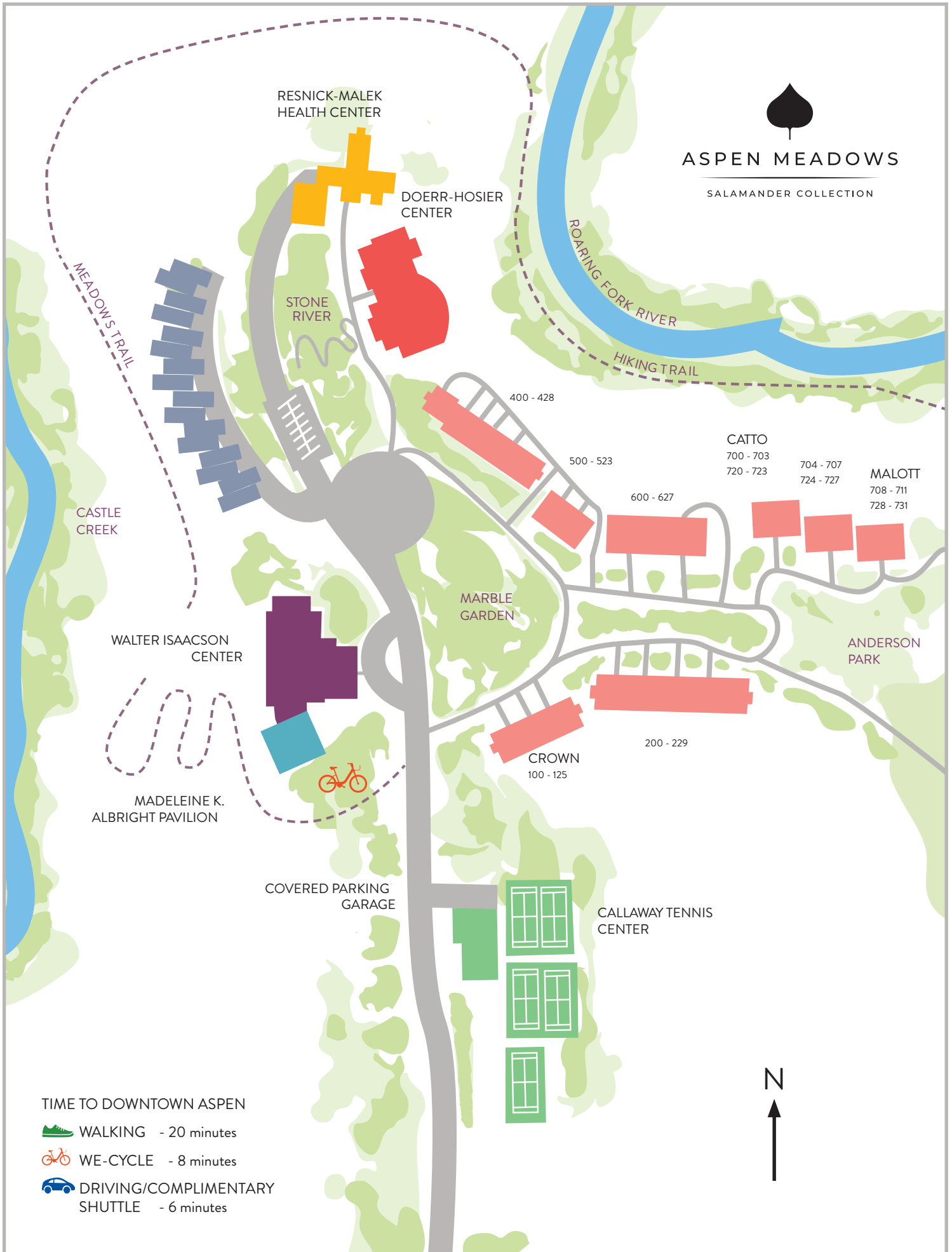

### TIME TO DOWNTOWN ASPEN

-  WALKING - 20 minutes
-  WE-CYCLE - 8 minutes
-  DRIVING/COMPLIMENTARY SHUTTLE - 6 minutes

