

WALKING TIME: 8 minutes
 1 Walter Isaacson Center to
 11 Walter Paepcke Memorial Building

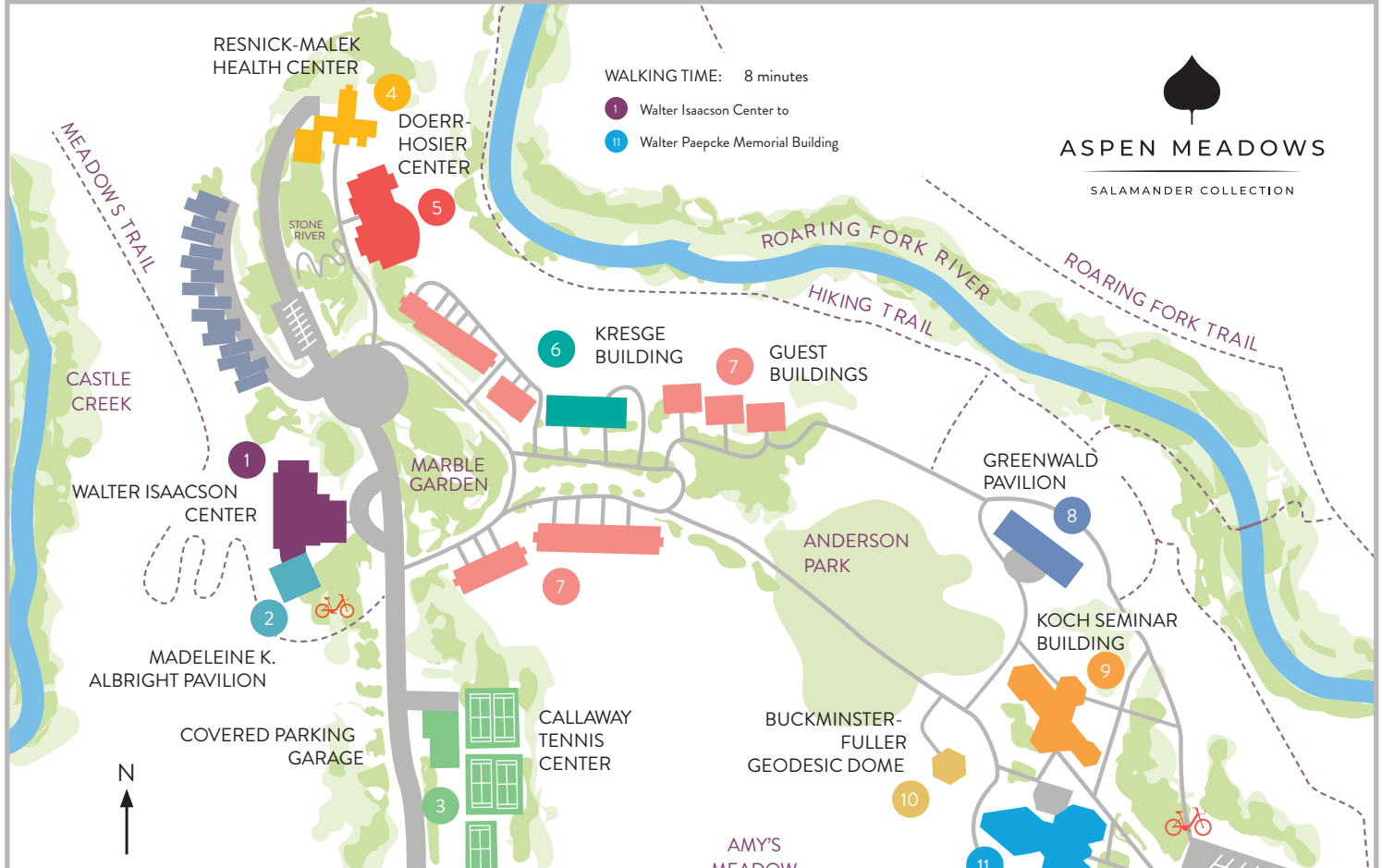

- 1** WALTER ISAACSON CENTER
Front Desk & Bell Stand . West End Social . Meadows Café . Moderator's Bridge
- 2** MADELEINE K. ALBRIGHT PAVILION
Bren and Mel Simon Terrace
- 3** COVERED PARKING GARAGE & TENNIS CENTER
- 4** RESNICK-MALEK HEALTH CENTER
Fitness Center . Swimming Pool . Hot Tub . Steam Rooms
- 5** DOERR-HOSIER CENTER
McNulty . Barksdale Lobby . Resnick Art Gallery . Kaufman . Catto . Murdock Lounge . Bass Terrace
- 6** KRESGE BUILDING
Hines
- 7** GUEST BUILDINGS
Crown 100s . Arco 200s . Wexner 400s . Wachner 500s . Kresge 600s . Catto 700 - 703 + 720 - 723 . Whitmore 704 - 707 + 724 - 727 . Malott 708 - 711 + 728 - 731
- 8** GREENWALD PAVILION (SEASONAL)
- 9** KOCH SEMINAR BUILDING
Lauder . Stranahan . Booz Allen Hamilton . Business Center
- 10** BUCKMINSTER-FULLER GEODESIC DOME
- 11** WALTER PAEPCKE MEMORIAL BUILDING
Auditorium . Gallery . Library
- 12** MICHAEL KLEIN MUSIC TENT & HARRIS HALL

- 13** ASPEN CENTER FOR PHYSICS
- 14** BOETTCHER SEMINAR BUILDING
Dingman . Harris . Hudson Commons
- 15** THE RESNICK CENTER FOR HERBERT BAYER STUDIES
- WE-CYCLE STATION
- RFTA CROSSTOWN SHUTTLE



ASPEN MEADOWS

SALAMANDER COLLECTION

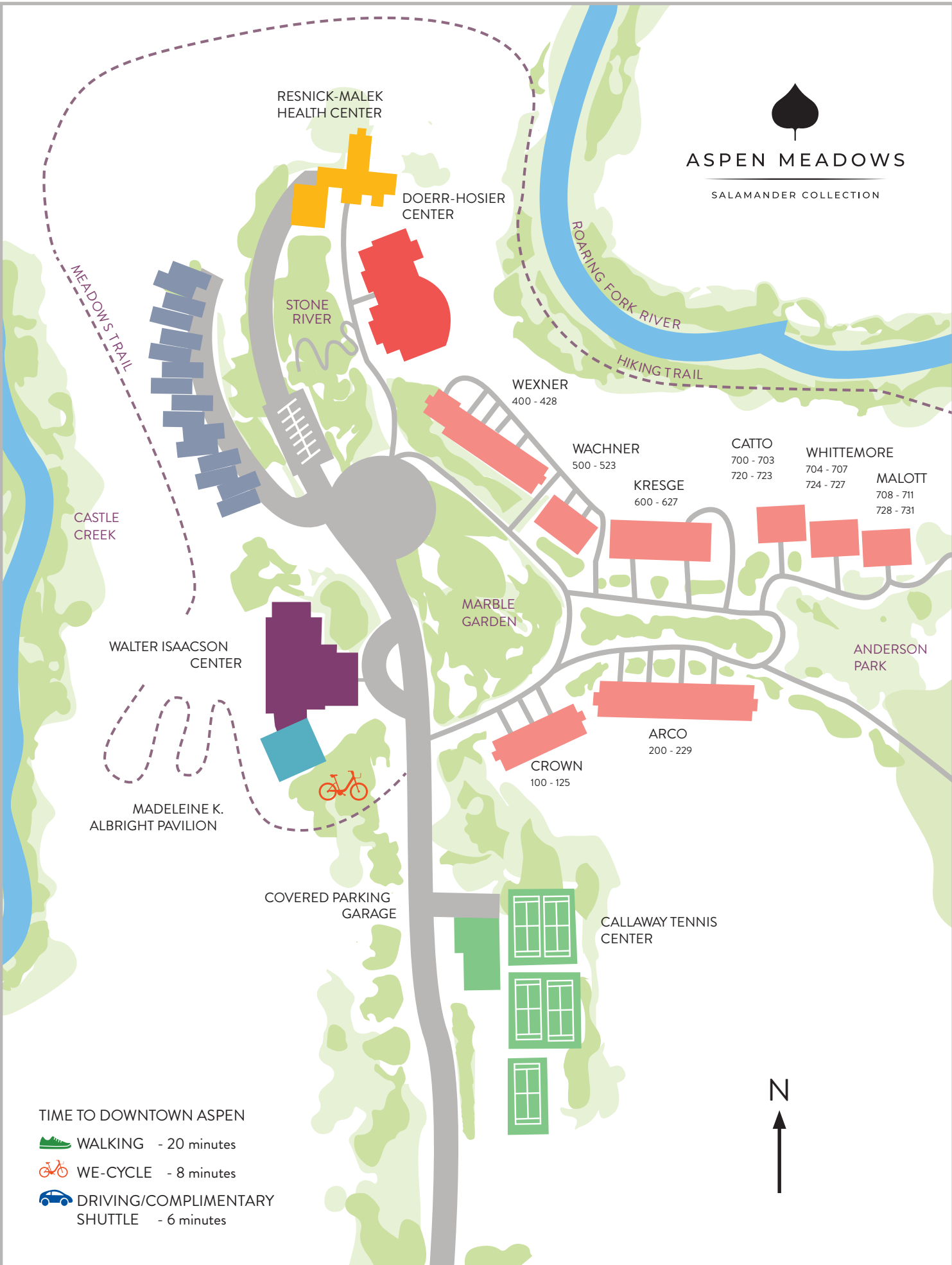

TIME TO DOWNTOWN ASPEN

-  WALKING - 20 minutes
-  WE-CYCLE - 8 minutes
-  DRIVING/COMPLIMENTARY SHUTTLE - 6 minutes

